

SANITARY SEWER STRUCTURE INVENTORY					
MH #	MH DIAMETER	MH OPSD	FRAME OPSD	TOP ELEV.	INVERTS
LIFT	2400mm \varnothing	701.013	401.010	272.50	N 268.90 (200mm \varnothing) E 268.90 (200mm \varnothing) SW 268.70 (75mm \varnothing)
MH1A	1200mm \varnothing	701.010	401.010	271.32	S 268.40 (200mm \varnothing)
MH2A	1200mm \varnothing	701.010	401.010	271.58	N 268.03 (200mm \varnothing) E 268.90 (200mm \varnothing) S 267.91 (200mm \varnothing)
MH3A	1200mm \varnothing	701.010	401.010	272.42	W 268.52 (200mm \varnothing)
MH4A	1200mm \varnothing	701.010	401.010	272.30	N 267.52 (200mm \varnothing) E 268.90 (200mm \varnothing) S 267.43 (200mm \varnothing)
MH5A	1200mm \varnothing	701.010	401.010	271.61	W 268.70 (200mm \varnothing)
MH6A	1200mm \varnothing	701.010	401.010	271.74	E 268.00 (200mm \varnothing) S 267.91 (200mm \varnothing)
MH7A	1200mm \varnothing	701.010	401.010	272.02	N 267.63 (200mm \varnothing) S 267.60 (200mm \varnothing)
MH8A	1200mm \varnothing	701.010	401.010	271.83	NE 271.06 (75mm \varnothing) W 271.03 (200mm \varnothing)
MH9A	1200mm \varnothing	701.010	401.010	274.82	E 270.81 (200mm \varnothing) SE 270.39 (200mm \varnothing)
MH10A	1200mm \varnothing	701.010	401.010	274.61	NE 270.48 (200mm \varnothing) SE 270.39 (200mm \varnothing) NW 270.39 (200mm \varnothing)

CATCHBASIN STRUCTURE INVENTORY					
CB #	CB STD.	FRAME OPSD	TOP ELEV.	INVERTS	
CB1	705.010	400.030	271.47	270.07 (200mm \varnothing)	
CB2	705.010	400.030	271.83	270.43 (200mm \varnothing)	
CB3	705.010	400.030	271.83	270.43 (200mm \varnothing)	
CB4	705.010	400.030	272.07	270.43 (200mm \varnothing)	
CB5	705.010	400.030	272.07	270.67 (250mm \varnothing)	
CB6	705.010	400.030	271.78	270.38 (200mm \varnothing)	
CB7	705.010	400.030	271.78	270.38 (200mm \varnothing)	
HCCB1	705.010	STEPCCON 5101	271.27	269.87 (75mm \varnothing)	
HCCB2	705.010	STEPCCON 5101	271.27	269.87 (200mm \varnothing)	
HCCB3	705.010	STEPCCON 5101	271.26	269.86 (200mm \varnothing)	
HCCB4	705.010	STEPCCON 5101	271.26	269.86 (200mm \varnothing)	
HCCB5	705.010	STEPCCON 5101	271.62	270.22 (200mm \varnothing)	
HCCB6	705.010	STEPCCON 5101	271.62	270.22 (200mm \varnothing)	
HCCB7	705.010	STEPCCON 5101	272.16	270.76 (200mm \varnothing)	
HCCB8	705.010	STEPCCON 5101	272.16	270.76 (250mm \varnothing)	
HCLRCB1	705.010	STEPCCON 5101	271.63	270.87 (200mm \varnothing)	
RLCB1	705.010	400.030	271.24	270.40 (200mm \varnothing)	
RLCB2	705.010	400.030	271.24	270.25 (200mm \varnothing)	
RLCB3	705.010	400.030	271.45	270.85 (200mm \varnothing)	
RLCB4	705.010	400.030	271.95	271.15 (200mm \varnothing)	
RLCB5	705.010	400.030	272.37	271.29 (200mm \varnothing)	
RLCB6	705.010	400.030	272.43	271.03 (200mm \varnothing)	
RLCB7	705.010	400.030	272.03	271.63 (200mm \varnothing)	

STORM SEWER STRUCTURE INVENTORY					
MH #	MH DIAMETER	MH OPSD	FRAME OPSD	TOP ELEV.	INVERTS
CBMH1	1200mm \varnothing	701.010	400.030	271.47	E 269.83 (250mm \varnothing) W 269.86 (250mm \varnothing)
CBMH3	1200mm \varnothing	701.010	400.030	272.20	N 271.21 (200mm \varnothing) W 271.18 (300mm \varnothing)
CBMH4	1200mm \varnothing	701.010	400.030	271.80	W 270.67 (200mm \varnothing) NW 270.67 (300mm \varnothing)
JELLYFISH	2400mm \varnothing	701.013	JF8-8-2	271.54	NE 269.12 (450mm \varnothing) W 269.29 (450mm \varnothing)
MH2	2400mm X 2900mm	N/A	401.010	271.76	S 270.08 (1800mm \varnothing) E 269.87 (200mm \varnothing) E 269.89 (1800mm \varnothing)
MH3	3000mm \varnothing	701.014	401.010	272.22	N 270.38 (1800mm \varnothing)
MH4	3000mm \varnothing	701.014	401.010	272.42	W 270.49 (200mm \varnothing) E 270.24 (1800mm \varnothing)
MH5	3000mm \varnothing	701.014	401.010	272.43	SE 270.28 (200mm \varnothing) W 270.22 (1800mm \varnothing)
MH6	2400mm X 2900mm	N/A	401.010	272.28	W 270.13 (1800mm \varnothing) E 270.13 (1800mm \varnothing) N 270.04 (1800mm \varnothing)
MH7	2400mm X 2900mm	N/A	401.010	271.83	S 269.88 (1800mm \varnothing) W 269.75 (1800mm \varnothing) N 269.68 (450mm \varnothing)
MH8	2400mm X 2900mm	N/A	401.010	271.42	S 269.69 (1800mm \varnothing) W 269.75 (1800mm \varnothing) N 269.68 (450mm \varnothing)
MH9	1200mm \varnothing	701.010	401.010	271.40	S 269.50 (450mm \varnothing) E 269.41 (450mm \varnothing)
MH10	1200mm \varnothing	701.010	401.010	271.54	W 269.37 (450mm \varnothing) E 269.38 (450mm \varnothing) E 269.31 (450mm \varnothing)
MH11	1200mm \varnothing	701.010	401.010	271.35	W 269.96 (450mm \varnothing) E 269.06 (450mm \varnothing) SW 269.14 (1450mm \varnothing)
MH12	1800mm \varnothing	701.012	401.010	271.39	S 269.03 (900mm \varnothing) W 269.89 (450mm \varnothing) N 268.22 (1050mm \varnothing)
MH13	1200mm \varnothing	701.010	401.010	272.69	S 270.41 (200mm \varnothing) NW 270.35 (200mm \varnothing)
MH14	1200mm \varnothing	701.010	401.010	272.21	S 271.04 (200mm \varnothing) E 270.95 (200mm \varnothing)
MH15	1200mm \varnothing	701.010	401.010	271.46	N 270.18 (200mm \varnothing) S 270.03 (200mm \varnothing) W 270.00 (200mm \varnothing)

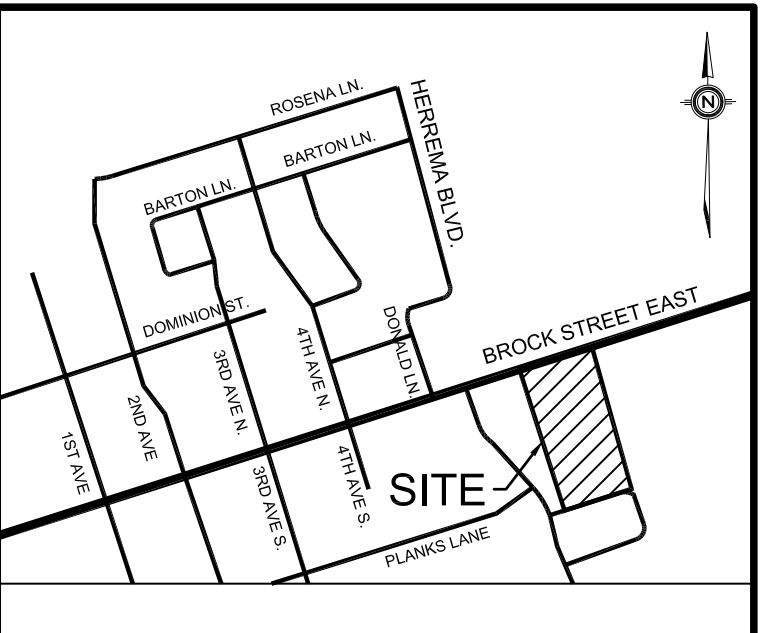
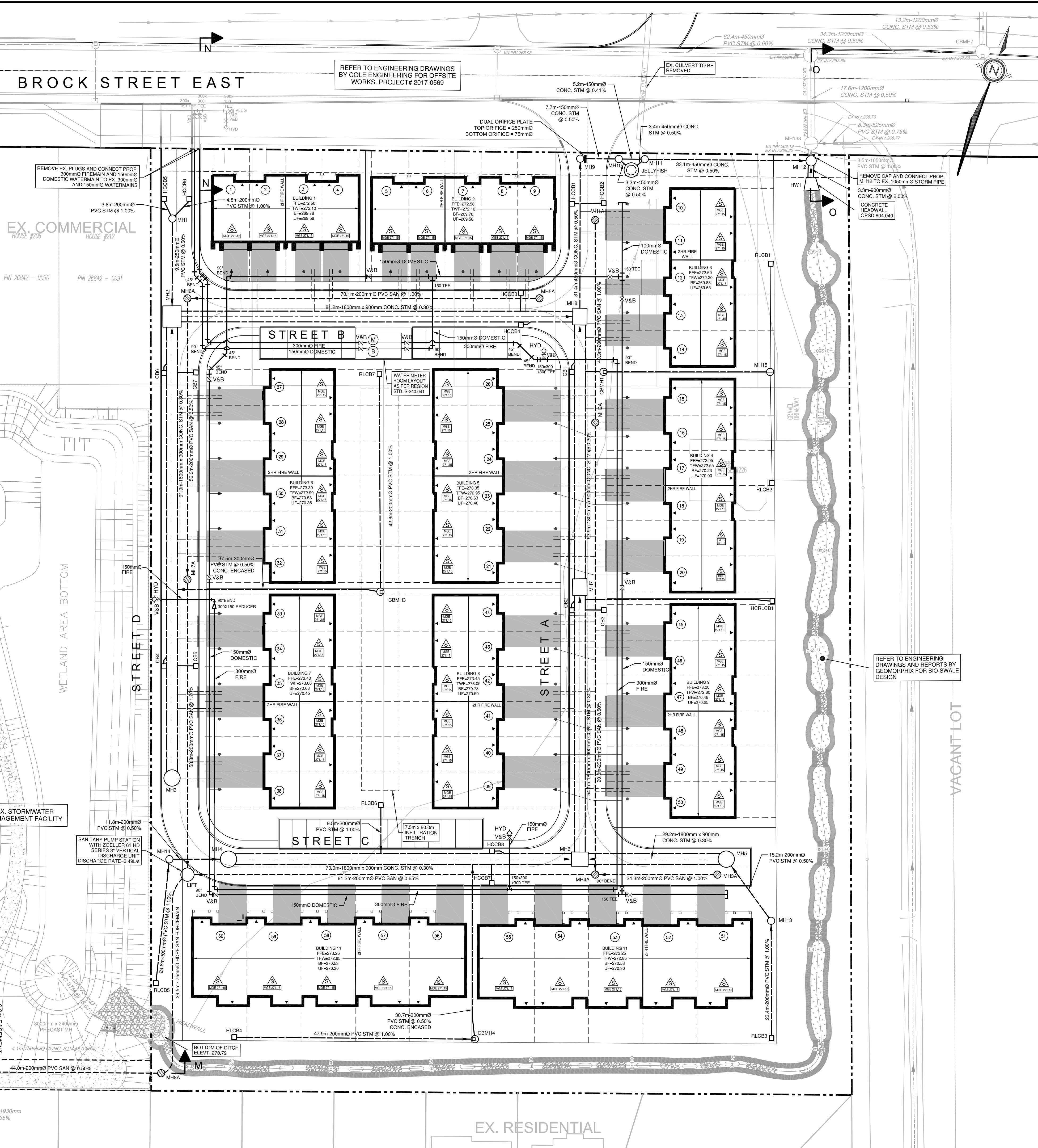

LEGEND

- PROPERTY LINE
- PROPOSED STORM PIPE
- PROPOSED SANITARY PIPE
- PROPOSED WATER
- PROPOSED 90° VERTICAL BEND
- PROPOSED SANITARY MANHOLE
- PROPOSED STORM MANHOLE
- PROPOSED CATCH BASIN MANHOLE
- PROPOSED CATCH BASIN
- PROPOSED OGS
- EXISTING MANHOLE
- EXISTING CATCH BASIN
- PROPOSED VALVE AND BOX
- PROPOSED FIRE HYDRANT
- PROPOSED SIAMESE CONNECTION
- SUMP PUMP
- LOT NUMBER
- PROPOSED BACKFLOW PREVENTOR
- PROPOSED WATER METER
- PROPOSED SUMP PUMP

LIST OF DRAWINGS

SG-01 - SITE GRADING PLAN
SS-01 - SITE SERVICING PLAN
XS-01 - CROSS SECTIONS
XS-02 - CROSS SECTIONS
EC-01 - EROSION CONTROL PLAN - PHASE 1
EC-02 - EROSION CONTROL PLAN - PHASE 2
EC-03 - EROSION CONTROL PLAN - PHASE 3
EC-04 - EROSION CONTROL DETAILS
DD-01 - DETAILS
DD-02 - DETAILS

SITE PLAN INFORMATION		SURVEYOR INFORMATION	
ICR ASSOCIATES INCORPORATED	12 SANDBOURNE CRESCENT TORONTO, ONTARIO L4K 4B5 PHONE: (416) 499-9427 E-MAIL: icr.dwg@gmail.com	H.F. GRANDER Co. LTD.	1575 HIGHWAY 7A WEST, UNIT 2A PORT FERRY, ONTARIO L1L 1A6 PHONE: (905) 965-3600 FAX: (905) 965-2347

NO.	REVISION	DATE	BY
4	ISSUED FOR SITE PLAN APPROVAL	MAR 19, 2021	LMV
3	ISSUED FOR ZONING APPROVAL	MAR 15, 2019	LMV
2	ISSUED FOR COORDINATION	SEPT 5, 2018	TVL
1	ISSUED FOR ZONING APPROVAL	AUG 10, 2018	LMV



TOWN OF UXBRIDGE
REGION OF DURHAM
WESTLANE DEVELOPMENT GROUP LTD.
SOUTH BROCK STREET DEVELOPMENT
UXBRIDGE, ONTARIO

SITE SERVICING PLAN

DESIGNED BY: LMV	DATE: JUNE 2018	CHECKED BY: JL
DRAWN BY: LMV	PROJECT No. 2018-0302	DRAWING No. SS-01
SCALE: 1:400		

NOTE:
1. ALL UNITS TO BE EQUIPPED WITH PRESSURE REDUCING VALVES.
2. ALL HYDRANTS TO HAVE 150mm \varnothing SERVICES LEADS.