

241 Reach St, 17:386, Unit Type, Persons per unit, P.F. = 1, 14, MAX 3.8, MIN 1.5, SKA SABOURIN KIMBLE & ASSOCIATES LTD. CONSULTING ENGINEERS, Designed By: KLD, Checked By: AK

SANITARY SEWER DESIGN

Table with columns: Location, Upstream Manhole, Downstream Manhole, Section Area (ha), Cumulative Area (ha), Residential Area, Known Lot Fabric, Additional Known Lot Fabric Type, Cumulative Flows, Commercial and Institutional, TOTAL FLOWS, PIPE DESIGN. Includes summary table for NORTH OF COLIN SANITARY DRAINAGE.

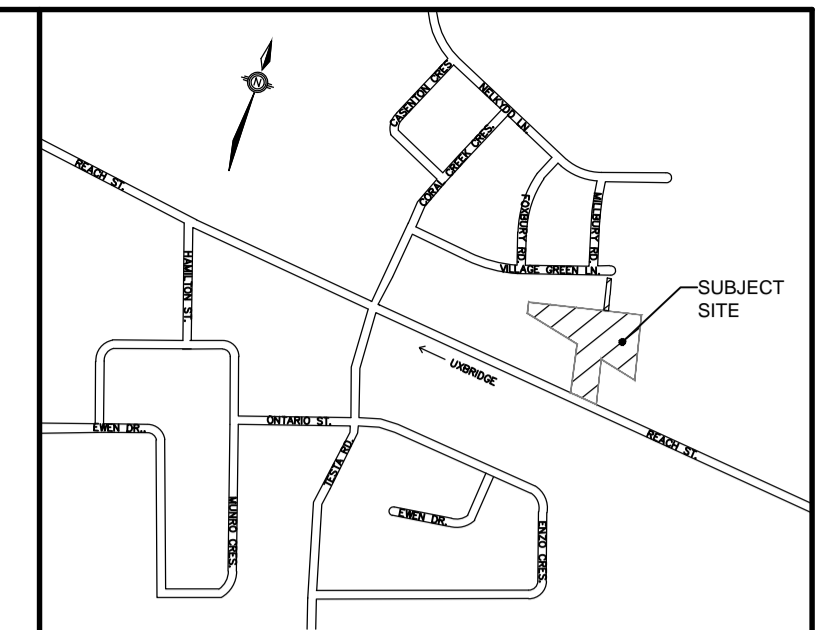

KEYMAP N.T.S.

REVIEWED BY: TOWNSHIP OF UXBRIDGE, DATE: TOWNSHIP ENGINEER FOR THE TOWNSHIP OF UXBRIDGE, APPROVED BY: REGION OF DURHAM, DATE: BENCHMARK: ELEVATIONS ARE GEODETIC AND REFERRED TO THE MTO MONUMENT NO. 778488, ELEVATION = 267.903 M.

NOTE: ALL DIMENSIONS AND ELEVATIONS IN METRES UNLESS NOTED OTHERWISE. ALL PIPE SIZES IN MILLIMETRES.

STORM SEWER DESIGN SHEET 5 YEAR, 25 YEAR, AND 100 YEAR STORMS TOWNSHIP OF UXBRIDGE

Main storm sewer design table with columns: STREET, Upstream MH, Downstream MH, various flow rates (Q), pipe size, grade, capacity, velocity, length, time, invert, % Capacity.

PROJECT INFORMATION: PROJECT: Reach Street, PROJECT NUMBER: 17:386, CLIENT: Venetian Group, DATE: March 2021, NOTES: Town IDF Curve, Regional IDF Curve, Design: KLD, Checked: AK

Table with columns: No., REVISIONS TO DRAWING, BY, DATE, APPR. Includes CLIENT: VENETIAN GROUP, MUNICIPALITY: TOWNSHIP OF UXBRIDGE, REGION OF DURHAM, PROJECT TITLE: REACH STREET LANDS, SHEET TITLE: SEWER DESIGN SHEETS

SKA SABOURIN KIMBLE & ASSOCIATES LTD. CONSULTING ENGINEERS logo and professional seal for A.E. KIMBLE, 26/03/2021, PROVINCE OF ONTARIO