

KEY MAP - NOT TO SCALE

SCHEME 'F7'

- 1. SITE AREA:**
 Total area = 3.62 ha (8.95 acre)
 1.1. Wood lot area = 0.15 ha
 1.2. LSRCA = 0.77 ha
 1.3. Net area = 2.70 ha (6.67 acre)
- 2. NUMBER OF UNITS:**
 TYPE 'A': 10.8 m BUNGALOW TOWNHOUSE: 1-1/2 STOREY = 37 UNITS
 TYPE 'C': 7.6m STREET TOWNHOUSES: 1-1/2 STOREY = 11 UNITS
 TYPE 'E': 7.6 m REAR LANE TOWNHOUSE: 1-1/2 STOREY = 14 UNITS
TOTAL = 62 UNITS
- 3. DENSITY: (NET AREA)**
 62 UNITS / 6.67ACRE = 9.30 UNITS PER ACRE
 62 UNITS / 2.70 HECTARE = 22.96 UNITS PER HECTARE
- 4. PARKING:**
 PARKING REQUIRED: 2.0 PER UNIT / 10.5 VISITOR SPACE

TYPE	#UNITS	RES. SPACES	VISITOR SPACES
TYPE 'A'	37	74	19
TYPE 'C'	11	22	6
TYPE 'E'	14	28	7
TOTAL	62	124	32

 PARKING PROVIDED:

TYPE	#UNITS	RES. SPACES	VISITOR SPACES
TYPE 'A'	37	74	74 (ON DRIVEWAY)
TYPE 'B'	11	22	22 (ON DRIVEWAY)
TYPE 'E'	14	28	28 (ON DRIVEWAY)
TOTAL	62	124	124 (4.48 / UNIT)

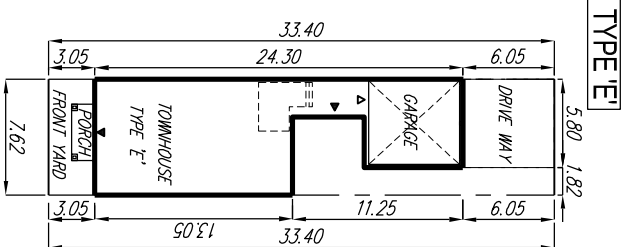
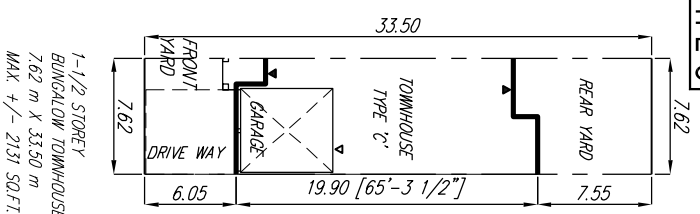
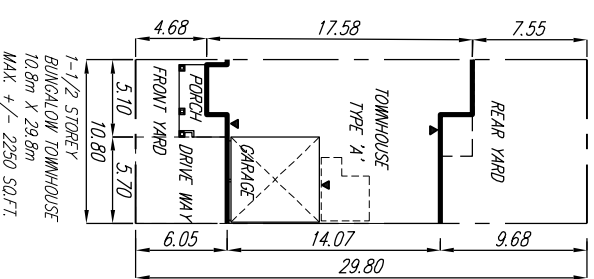

5. AREA BALANCE OF LSRCA LINE AND WOOD LOT:

DEFINITION	AREA	LEGEND
AREA OF ENCROACHMENT LSRCA LINE AND WOOD LOT (TAKEN)	-521.36 sqm	-5611.87 sq.ft.
AREA OF CONSERVED WOOD LOT	1374.87 sqm	14798.98 sq.ft.
AREA OF ADDITIONAL LANDS OUTSIDE OF LSRCA TO BE CONVENED TO LSRCA (GIVEN)	+84.80 sqm	+912.78 sq.ft.
RESULT (LSRCA COMPENSATION)	-436.56 sqm	-4699.09 sq.ft.

LEGEND:

	OBSOLETE REAR YARD BOUNDARY		STAKE LINE
	PROPOSED REAR YARD BOUNDARY		FIRE ROUTE
	LSRCA LINE		PROPERTY LINE
			GROUND PARKING SPACE

SITE PLAN

SCALE: 1:1000



VENETIAN GROUP - 217049
 REACH STREET, UXBRIDGE, ONTARIO
 DESIGN ASSOCIATES INC.
 8966 Woodbine Ave, Markham, ON L3R 0J7 ■ T 905.737.5133 ■ F 905.737.7326 ■ FEB. 4, 2019 ■ SY ■

VENETIAN GROUP - 217049
 REACH STREET, UXBRIDGE, ONTARIO
 DESIGN ASSOCIATES INC.
 8966 Woodbine Ave, Markham, ON L3R 0J7 ■ T 905.737.5133 ■ F 905.737.7326 ■ FEB. 4, 2019 ■ SY ■

217049DSP01-SCHEME F7
 SCALE: 1:1000